

### Clamp pipe connection DIN 32676, flange Ø 34–319

Art.No	EUR	Art.No	EUR
--------	-----	--------	-----

#### Clamp gasket DIN

DN	A	B				VMQ		VMQ USP VI	
250 *	268	250,2				220746	Enquiry	223946	Enquiry
300 *	319	300,2				220748	Enquiry	223948	Enquiry

\* Similar to DIN 32676

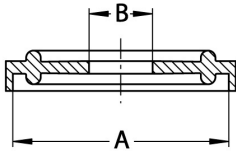

#### Clamp gasket DIN, enveloped

DN	A	B				PTFE-FKM		PTFE-FKM USP VI	
10	34	10				221830	11,40	224830	Enquiry
15	34	16				221831	11,40	224831	Enquiry
20	34	20				221832	11,40	224832	Enquiry
25	50,5	26				221833	12,70	224833	Enquiry
32	50,5	32				221834	12,70	224834	Enquiry
40	50,5	38				221835	12,70	224835	Enquiry
50	64	50				221836	13,20	224836	Enquiry
65	91	66				221837	17,60	224837	Enquiry
80	106	81				221838	18,70	224838	Enquiry
100	119	100				221839	20,60	224839	Enquiry
115	130	109,7				221809	22,00	224809	Enquiry
125	155	125				221841	28,50	224841	Enquiry
150	183	150				221842	37,80	224842	Enquiry
200	233,5	200				221844	54,90	224844	Enquiry
250	268	250				221846	71,50	224846	Enquiry
300	319	300				221848	83,60	224848	Enquiry

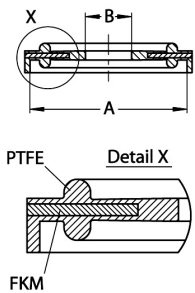

#### Clamp gasket ASME

DN	A	B				EPDM		EPDM USP VI	
1"	50,5	23,1				225703	1,30	225603	Enquiry
1,5"	50,5	35,3				225704	1,30	225604	Enquiry
2"	64	48				225705	1,70	225605	Enquiry
2,5"	77,5	60,7				225706	2,30	225606	Enquiry
3"	91	73,1				225707	2,80	225607	Enquiry
4"	119	97,8				225708	4,30	225608	Enquiry
4,5" *	130	110,5				225709	11,50	225609	Enquiry
5,5" *	155	135,9				225710	13,10	225610	Enquiry
6,6" *	183	163,3				225711	15,40	225611	Enquiry
8,6" *	233,5	214,1				225712	18,30	225612	Enquiry

\* Similar to DIN 32676

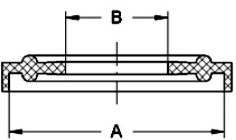

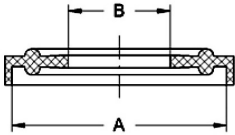
Clamp pipe connection DIN 32676, flange Ø 34–319						Art.No	EUR	Art.No	EUR
Clamp gasket ASME 	DN	A	B			FKM		FKM USP VI	
	1"	50,5	23,1			225903	4,60	224303	Enquiry
	1,5"	50,5	35,3			225904	4,60	224304	Enquiry
	2"	64	48			225905	5,50	224305	Enquiry
	2,5"	77,5	60,7			225906	7,80	224306	Enquiry
	3"	91	73,1			225907	9,40	224307	Enquiry
	4"	119	97,8			225908	11,90	224308	Enquiry
	4,5" *	130	110,5			225909	16,70	224309	Enquiry
	5,5" *	155	135,9			225910	22,30	224310	Enquiry
	6,6" *	183	163,3			225911	25,40	224311	Enquiry
8,6" *	233,5	214,1			225912	34,70	224312	Enquiry	

\* Similar to DIN 32676

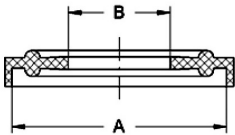
Clamp gasket ASME 	DN	A	B			PTFE		PTFE USP VI	
	1"	50,5	22,1			225403	9,60	226003	Enquiry
	1,5"	50,5	34,8			225404	9,60	226004	Enquiry
	2"	64	47,5			225405	10,60	226005	Enquiry
	2,5"	77,5	60,2			225406	14,30	226006	Enquiry
	3"	91	72,8			225407	16,20	226007	Enquiry
	4"	119	97,38			225408	19,70	226008	Enquiry
	4,5"	130	109,7			225409	21,30	226009	Enquiry
	5,5"	155	134,5			225410	27,40	226010	Enquiry
	6,6"	183	163,1			225411	35,90	226011	Enquiry
8,6"	233,5	213,9			225412	49,40	226012	Enquiry	

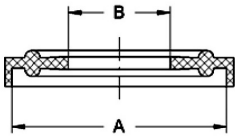
Clamp gasket ASME 	DN	A	B			VMQ		VMQ USP VI	
	1"	50,5	23,1			225803	1,40	224003	Enquiry
	1,5"	50,5	35,3			225804	1,40	224004	Enquiry
	2"	64	48			225805	1,90	224005	Enquiry
	2,5"	77,5	60,7			225806	2,80	224006	Enquiry
	3"	91	73,1			225807	3,20	224007	Enquiry
	4"	119	97,8			225808	4,80	224008	Enquiry
	4,5" *	130	110,5			225809	13,60	224009	Enquiry
	5,5" *	155	135,9			225810	15,70	224010	Enquiry
	6,6" *	183	163,3			225811	18,30	224011	Enquiry
8,6" *	233,5	214,1			225812	25,50	224012	Enquiry	

\* Similar to DIN 32676